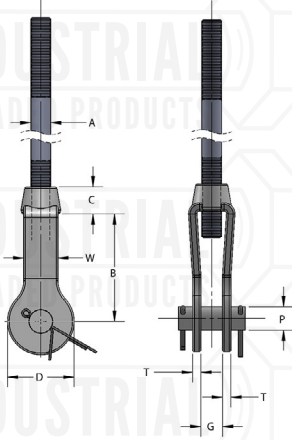



**FIG. 909
FORGED STEEL CLEVIS, DOMESTIC**
**FIG. 909I
FORGED STEEL CLEVIS**



Manufactured
in the USA
Excluding 909I



Material: Forged steel, also available in 304 and 316 stainless steel.
Finish: Plain, electro-galvanized, or hot-dip galvanized.
Service: Designed for use on high temperature piping installations.
Approvals: Complies with Federal Specification WW-H-171-E (Type# 14), A-A-1192A (Type# 14) and Manufacturers' Standardization Society MSS SP 58 and SP 69 (Type# 14).
Ordering: Specify size number, rod size, finish and part number. If other than standard dimension sizes required, specify size number, rod size, pin size and grip.
Notes: Forged clevis are standardly supplied with pin and cotter pins. When figure number 909 I is supplied hot-dip galvanized the threading is not tapped oversize.

SIZE A	CLEVIS SIZE NO.	B	C	D	G GRIP	P PIN DIA.	T	W	WGT EACH (lbs)	MAX REC LOAD (lbs)	
										650°F	750°F
3/8-16	2	3 9/16	5/8	1 7/16	1/2	1/2	5/16	1 1/16	1.0	610	540
1/2-13	2	3 9/16	5/8	1 7/16	1/2	5/8	5/16	1 1/16	1.0	1130	1010
5/8-11	2	3 9/16	5/8	1 7/16	5/8	3/4	5/16	1 1/16	1.1	1810	1610
3/4-10	2 1/2	4	1	2 1/2	3/4	7/8	5/16	1 1/4	2.3	2710	2420
7/8-9	2 1/2	4	1	2 1/2	7/8	1	5/16	1 1/4	2.5	3770	3360
1-8	3	5 1/16	1 1/4	3	1	1 1/8	1/2	1 1/2	5.1	4960	4420
1 1/8-7	3	5 1/16	1 1/4	3	1 1/8	1 1/4	1/2	1 1/2	5.2	6230	5560
1 1/4-7		3 1/2	5 1/16	1 1/4	3	1 1/4	1 3/8	1/2	1 1/2	5.6	8000
1 1/2-6	4	6	1 1/2	3 1/2	1 1/2	1 5/8	1/2	1 3/4	8.1	11630	10370
1 3/4-5		6	1 3/4	4	1 3/4	1 7/8	1/2	2	9.0	14700	14000

Project Information		Approval Stamp
Project:		Notes:
Address:	Contractor:	
Date:	Engineer:	
Approved <input type="checkbox"/>	Approved as Noted <input type="checkbox"/>	Not Approved <input type="checkbox"/>