

9077WF

9-HOLE TRIPLE WING CON- NECTION

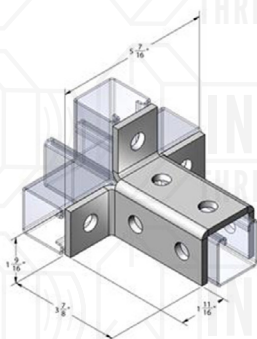

Material: 1/4"
Finish: Electro-Galvanized, SST 316 & 304
Hole Dim: 9/16"
Wt. Each (lbs): 1.77

9078WF

8-HOLE DOUBLE WING CON- NECTION

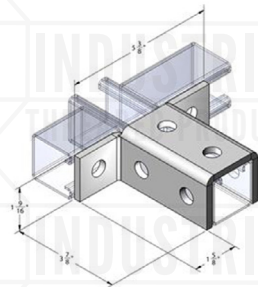

Material: 1/4"
Finish: Electro-Galvanized, SST 316 & 304
Hole Dim: 9/16"
Wt. Each (lbs): 1.56

9079WF

12-HOLE TRIPLE WING CON- NECTION

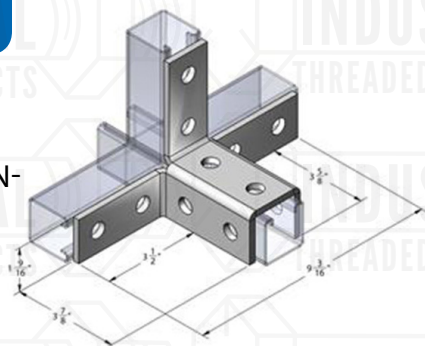

Material: 1/4"
Finish: Electro-Galvanized, SST 316 & 304
Hole Dim: 9/16"
Wt. Each (lbs): 2.34

9080WF

10-HOLE DOUBLE WING CON- NECTION

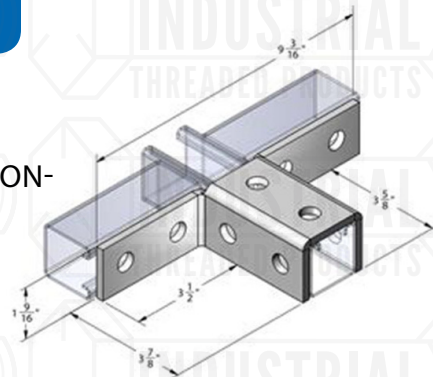

Material: 1/4"
Finish: Electro-Galvanized, SST 316 & 304
Hole Dim: 9/16"
Wt. Each (lbs): 1.93

9081BC

STRUT BEAM CLAMP NOTCHED

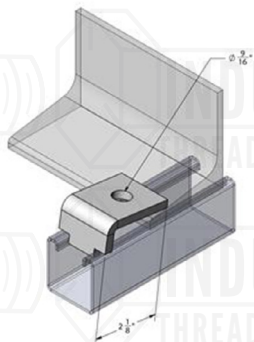

Material is 1-5/8" wide x 1/4" thick
Clamp requires 1/2"-13 HCS and 1/2" channel nut

Design load 1100 lbs when used in pairs

Material: 1/4"
Finish: Electro-Galvanized, SST 316 & 304
Hole Dim: 9/16"
Wt. Each (lbs): .28

9082BC

STRUT BEAM CLAMP LIGHT DUTY 1/4" THICK

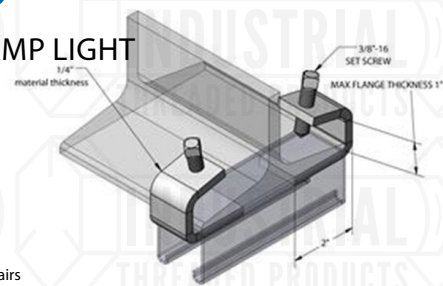

Max flange thickness 1"
3/8"-16 set screw

Design load 550 lbs when used in pairs

Material: 1/4"
Finish: Electro-Galvanized, SST 316 & 304
Hole Dim: 9/16"
Wt. Each (lbs): .62