

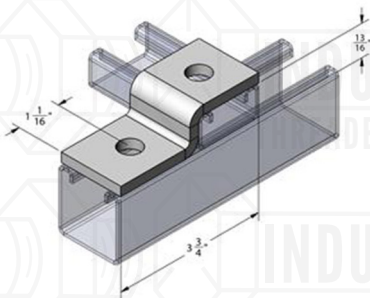

9059ZF

2-HOLE "Z"
SUPPORT FOR 1-5/8"
X 13/16"
STRUT



Material: 1/4"
Finish: Electro-Galvanized, SST 316 & 304
Hole Dim: 9/16"
Wt. Each (lbs): .43

9060ZF

2-HOLE "Z"
SUPPORT FOR 1-5/8"
X 13/16"
STRUT

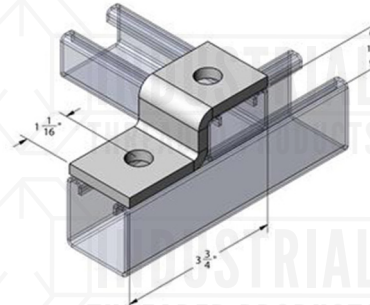

Material: 1/4"
Finish: Electro-Galvanized, SST 316 & 304
Hole Dim: 9/16"
Wt. Each (lbs): .44

9061ZF

2-HOLE "Z"
SUPPORT FOR 1-5/8"
X 1-3/8"
STRUT

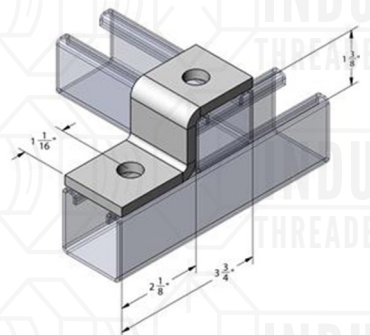

Material: 1/4"
Finish: Electro-Galvanized, SST 316 & 304
Hole Dim: 9/16"
Wt. Each (lbs): .51

9062ZF

2-HOLE "Z"
SUPPORT FOR 1-5/8"
X 1-5/8"
STRUT

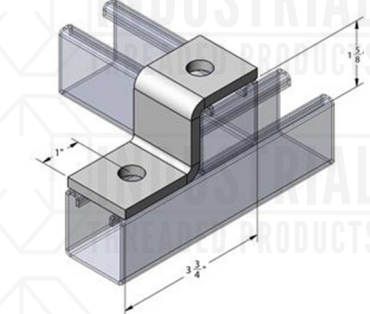

Material: 1/4"
Finish: Electro-Galvanized, SST 316 & 304
Hole Dim: 9/16"
Wt. Each (lbs): .52

9063ZF

2-HOLE "Z"
SUPPORT FOR 1-5/8" X
2-7/16" STRUT

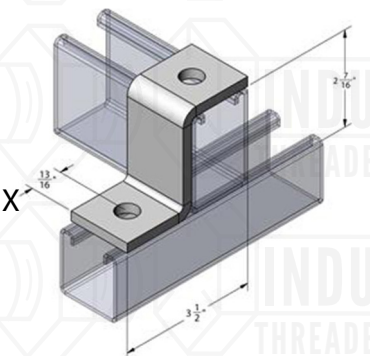

Material: 1/4"
Finish: Electro-Galvanized, SST 316 & 304
Hole Dim: 9/16"
Wt. Each (lbs): .64

9064ZF

HOLE "Z"
SUPPORT FOR 1-5/8"
X 3-1/4" STRUT OR
STRUT COMBINATION

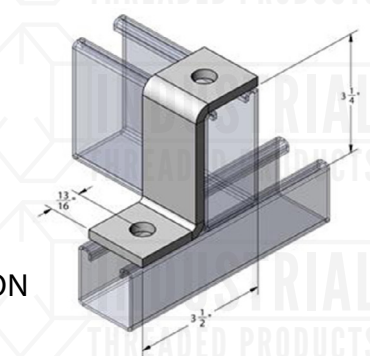

Material: 1/4"
Finish: Electro-Galvanized, SST 316 & 304
Hole Dim: 9/16"
Wt. Each (lbs): .70