

9047AF

2-HOLE CLOSED AN-
GLE 45°
2-1/2" X 3-1/2"

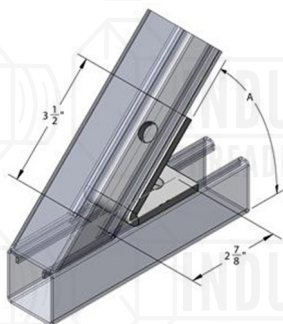

Material: 1/4"
Finish: Electro-Galvanized, SST 316 & 304
Hole Dim: 9/16"
Wt. Each (lbs): .56

9048AF

4-HOLE CLOSED AN-
GLE 45°
4-3/8" X 5"

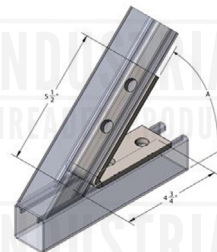

Material: 1/4"
Finish: Electro-Galvanized, SST 316 & 304
Hole Dim: 9/16"
Wt. Each (lbs): .95

9049UF

3-HOLE "U"
SUPPORT FOR
1-5/8" X 13/16" STRUT

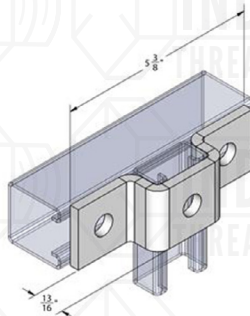

Material: 1/4"
Finish: Electro-Galvanized, SST 316 & 304
Hole Dim: 9/16"
Wt. Each (lbs): .70

9050UF

3-HOLE "U"
SUPPORT FOR
1-5/8" X 1" STRUT

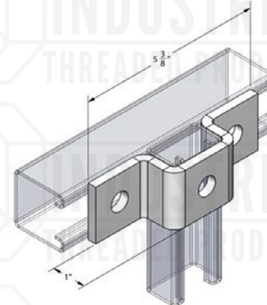

Material: 1/4"
Finish: Electro-Galvanized, SST 316 & 304
Hole Dim: 9/16"
Wt. Each (lbs): .71

9051UF

3-HOLE "U"
SUPPORT FOR 1-5/8" X
1-3/8" STRUT

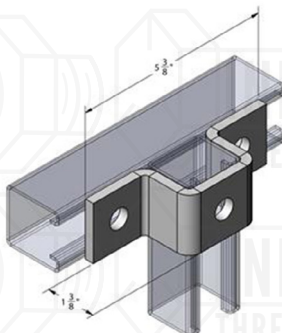

Material: 1/4"
Finish: Electro-Galvanized, SST 316 & 304
Hole Dim: 9/16"
Wt. Each (lbs): .84

9052UF

4-HOLE SPLICE CLE
IS FOR
1-5/8" X 1-5/8" STRUT

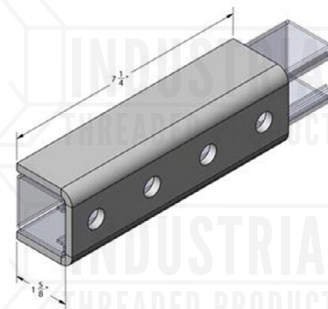

Material: 1/4"
Finish: Electro-Galvanized, SST 316 & 304
Hole Dim: 9/16"
Wt. Each (lbs): 2.33