

## 9034CA

7-HOLE  
UNIVERSAL  
CORNER ANGLE  
4-<sup>1</sup>/<sub>8</sub>" X 4-<sup>1</sup>/<sub>8</sub>"

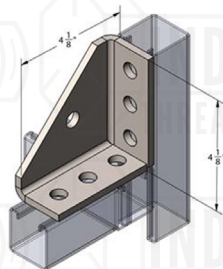

Material:	1/4"
Finish:	Electro-Galvanized, SST 316 & 304
Hole Dim:	9/16"
Wt. Each (lbs):	1.32

## 9035CA

3-HOLE SHELF GUS-  
SET ANGLE 1-<sup>5</sup>/<sub>8</sub>" X  
2-<sup>1</sup>/<sub>4</sub>"

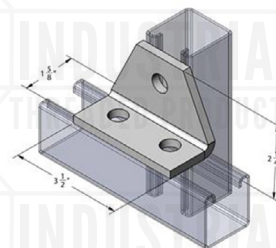

Material:	1/4"
Finish:	Electro-Galvanized, SST 316 & 304
Hole Dim:	9/16"
Wt. Each (lbs):	.67

## 9036CA

4-HOLE SHELF GUS-  
SET ANGLE 1-<sup>5</sup>/<sub>8</sub>" X  
4-<sup>1</sup>/<sub>8</sub>"

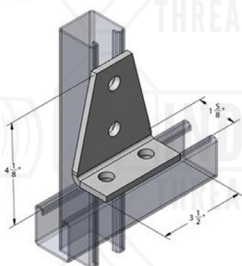

Material:	1/4"
Finish:	Electro-Galvanized, SST 316 & 304
Hole Dim:	9/16"
Wt. Each (lbs):	1.02

## 9037CA

4-HOLE SHELF GUS-  
SET  
3-WAY ANGLE  
2-<sup>1</sup>/<sub>4</sub>" X 3-<sup>1</sup>/<sub>2</sub>"

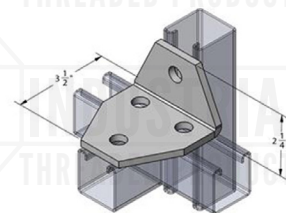

Material:	1/4"
Finish:	Electro-Galvanized, SST 316 & 304
Hole Dim:	9/16"
Wt. Each (lbs):	1.01

## 9038CA

5-HOLE SHELF GUS-  
SET  
3-WAY ANGLE  
3-<sup>1</sup>/<sub>2</sub>" X 4-<sup>1</sup>/<sub>8</sub>"

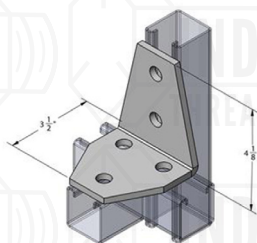

Material:	1/4"
Finish:	Electro-Galvanized, SST 316 & 304
Hole Dim:	9/16"
Wt. Each (lbs):	1.35

## 9039CA

5-HOLE SHELF GUS-  
SET ANGLE 1-<sup>5</sup>/<sub>8</sub>" X  
4-<sup>1</sup>/<sub>8</sub>"

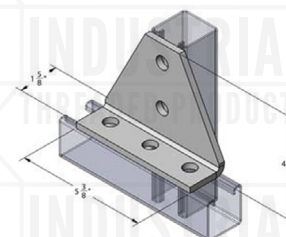

Material:	1/4"
Finish:	Electro-Galvanized, SST 316 & 304
Hole Dim:	9/16"
Wt. Each (lbs):	1.41