

9016FF

4-HOLE TEE PLATE 3-1/2" X 5-3/8"

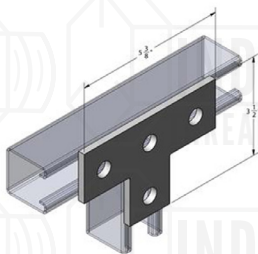

Material: 1/4"
Finish: Electro-Galvanized, SST 316 & 304
Hole Dim: 9/16"
Wt. Each (lbs): .75

9017FF

5-HOLE CROSS PLATE 5-3/8" X 5-3/8"

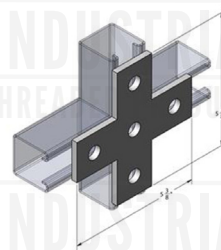

Material: 1/4"
Finish: Electro-Galvanized, SST 316 & 304
Hole Dim: 9/16"
Wt. Each (lbs): 1.00

9018FF

4-HOLE TEE GUSSET 3-1/2" X 5-3/8"

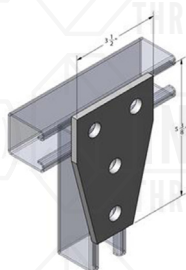

Material: 1/4"
Finish: Electro-Galvanized, SST 316 & 304
Hole Dim: 9/16"
Wt. Each (lbs): 1.00

9019FF

5-HOLE TEE GUSSET 5-3/8" X 5-3/8"

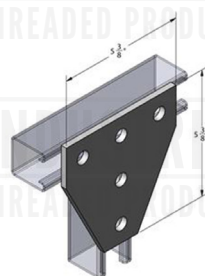

Material: 1/4"
Finish: Electro-Galvanized, SST 316 & 304
Hole Dim: 9/16"
Wt. Each (lbs): 1.43

9020FF

5-HOLE CORNER GUSSET 5-3/8" X 5-3/8"

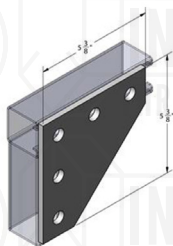

Material: 1/4"
Finish: Electro-Galvanized, SST 316 & 304
Hole Dim: 9/16"
Wt. Each (lbs): 1.45

9021FF

7-HOLE CROSS GUS- SET 5-3/8" X 9-1/8"

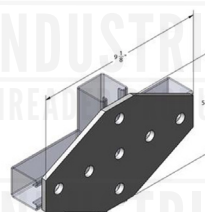

Material: 1/4"
Finish: Electro-Galvanized, SST 316 & 304
Hole Dim: 9/16"
Wt. Each (lbs): 2.32