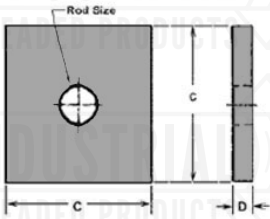



FIG. 75
STEEL WASHER PLATE



Manufactured
in the USA



Material/Finish: Carbon steel 304 stainless steel 316 stainless steel
 Plain electro-galvanized

Service: Designed as a heavy duty washer to suspend hanger rods.

Ordering: Specify rod size, thickness, length and width, and figure number.

Notes: Other sizes and dimensions available on request.

PLATE SIZE D x C x C	WEIGHT EACH (lbs) LENGTH					
	3/8	1/2	5/8	3/4	7/8	1
1/4 x 2 x 2	0.26	0.26	—	—		
1/4 x 3 x 3	0.64	0.64	0.64	0.64	0.63	0.63
1/4 x 4 x 4	1.15	1.15	1.15	1.10	1.10	1.06
3/8 x 2 x 2	1.72	1.72	1.72	1.71	1.70	1.70

Project Information		Approval Stamp
Project:		Notes:
Address:	Contractor:	
Date:	Engineer:	
Approved <input type="checkbox"/>	Approved as Noted <input type="checkbox"/>	Not Approved <input type="checkbox"/>