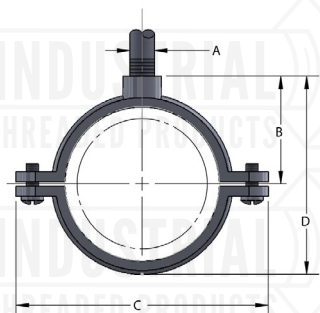

**FIG. 41SSI**  
**304 STAINLESS STEEL**
**FIG. 41SXI**  
**316 STAINLESS STEEL SPLIT RING EXTENSION HANGER**

**Material:** 304 (41SSI) and 316 (41SXI) stainless steel.

**Service:** Designed for suspension of non-insulated stationary pipe lines horizontally or vertically.

**Approvals:** Complies with Manufacturers' Standardization Society MSS SP-58 and SP-69 (Type# 12).

**Ordering:** Specify pipe size, material and finish.

**Notes:** 304 and 316 stainless steel are recommended for applications where protection from corrosive environments is needed.

PIPE SIZE	PIPE OD	SCREW	A	B	C	D	WEIGHT EACH (lbs)	MAX REC LOAD (lbs)
$\frac{3}{8}$	0.675	10-24	$\frac{3}{8}$ -16	$1\frac{1}{16}$	$1\frac{13}{16}$	$1\frac{3}{16}$	0.084	180
$\frac{1}{2}$	0.840		$\frac{3}{8}$ -16	$\frac{3}{4}$	$2\frac{1}{8}$	$1\frac{3}{16}$	0.098	
$\frac{3}{4}$	1.050		$\frac{3}{8}$ -16	$\frac{7}{8}$	$2\frac{1}{2}$	$1\frac{9}{16}$	0.112	
1	1.315		$\frac{3}{8}$ -16	$1\frac{1}{8}$	$2\frac{3}{4}$	2	0.147	
$1\frac{1}{4}$	1.660		$\frac{3}{8}$ -16	$1\frac{5}{16}$	$3\frac{3}{16}$	$2\frac{3}{8}$	0.181	
$1\frac{1}{2}$	1.900		$\frac{3}{8}$ -16	$1\frac{7}{16}$	$3\frac{3}{8}$	$2\frac{5}{8}$	0.214	
2	2.375		$\frac{3}{8}$ -16	$1\frac{5}{8}$	$3\frac{15}{16}$	$3\frac{1}{16}$	0.300	
$2\frac{1}{2}$	2.875	$\frac{1}{4}$	$\frac{1}{2}$ -13	$2\frac{1}{8}$	$5\frac{3}{16}$	$3\frac{13}{16}$	0.580	300
3	3.500		$\frac{1}{2}$ -13	$2\frac{1}{2}$	$5\frac{11}{16}$	$4\frac{5}{8}$	0.720	
4	4.500		$\frac{1}{2}$ -13	$2\frac{7}{8}$	$6\frac{3}{4}$	$5\frac{9}{16}$	1.020	

Project Information		Approval Stamp
Project:		Notes:
Address:	Contractor:	
Date:	Engineer:	
Approved <input type="checkbox"/> Approved as Noted <input type="checkbox"/> Not Approved <input type="checkbox"/>		