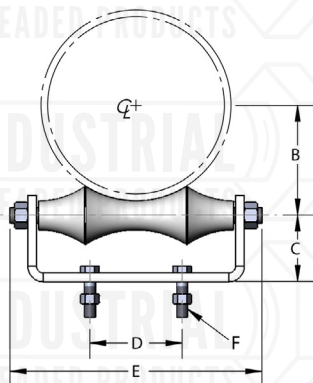

**FIG. 275**  
**ROLLER CHAIR**

- Material:** Carbon steel chair and axle with cast iron roller. Carbon steel chain and Axle also available in stainless steel.
- Finish:** Plain, electro-galvanized or painted.
- Service:** Designed for the support of pipe where longitudinal movement may occur due to expansion and contraction, and vertical adjustment is not necessary. May be bolted or welded to supporting member.
- Ordering:** Specify roller size, figure number and finish. Please remember to consider insulation thickness when sizing rollers.
- Notes:** Also available in 304 stainless steel (275SS).  
Available domestic

| HANGER SIZE | MATERIAL SIZE         | AXLE SIZE       | B                 | C                 | D                | E                 | F             | WGT EACH (lbs) | MAX REC LOAD (lbs) |
|-------------|-----------------------|-----------------|-------------------|-------------------|------------------|-------------------|---------------|----------------|--------------------|
| 2           | 4ga x 1.25            | $\frac{3}{8}$   | $\frac{19}{16}$   | $1 \frac{3}{8}$   | $1 \frac{1}{4}$  | $4 \frac{1}{4}$   | $\frac{3}{8}$ | 0.94           | 390                |
| 2 1/2       | 4ga x 1.25            | $\frac{1}{2}$   | $1 \frac{7}{8}$   | $1 \frac{5}{8}$   | $1 \frac{1}{4}$  | $4 \frac{7}{8}$   | $\frac{3}{8}$ | 1.18           | 390                |
| 3           | 4ga x 1.25            | $\frac{1}{2}$   | $2 \frac{1}{8}$   | $1 \frac{3}{4}$   | 2                | $5 \frac{11}{32}$ | $\frac{3}{8}$ | 1.32           | 390                |
| 3 1/2       | $\frac{3}{8}$ x 1.500 | $\frac{1}{2}$   | $2 \frac{1}{2}$   | 2                 | $2 \frac{1}{2}$  | $6 \frac{11}{32}$ | $\frac{3}{8}$ | 2.58           | 390                |
| 4           | $\frac{3}{8}$ x 1.500 | $\frac{1}{2}$   | $2 \frac{13}{16}$ | $2 \frac{5}{16}$  | 2                | $7 \frac{11}{32}$ | $\frac{1}{2}$ | 2.94           | 950                |
| 5           | $\frac{3}{8}$ x 1.500 | $\frac{5}{8}$   | $3 \frac{3}{8}$   | $2 \frac{1}{2}$   | 3                | $8 \frac{1}{4}$   | $\frac{1}{2}$ | 3.64           | 950                |
| 6           | $\frac{3}{8}$ x 2.00  | $\frac{3}{4}$   | $3 \frac{15}{16}$ | $2 \frac{3}{4}$   | $3 \frac{1}{8}$  | $9 \frac{1}{2}$   | $\frac{1}{2}$ | 5.72           | 950                |
| 7           | $\frac{3}{8}$ x 2.00  | $\frac{3}{4}$   | $4 \frac{1}{2}$   | $2 \frac{13}{16}$ | $3 \frac{3}{8}$  | 10                | $\frac{1}{2}$ | 6.98           | 1350               |
| 8           | $\frac{3}{8}$ x 2.00  | $\frac{7}{8}$   | $5 \frac{1}{8}$   | 3                 | $3 \frac{3}{8}$  | $12 \frac{1}{4}$  | $\frac{5}{8}$ | 8.16           | 1350               |
| 10          | $\frac{1}{2}$ x 2     | $\frac{7}{8}$   | $6 \frac{3}{8}$   | $3 \frac{5}{8}$   | 5                | $14 \frac{1}{2}$  | $\frac{5}{8}$ | 11.96          | 1730               |
| 12          | $\frac{1}{2}$ x 2     | $\frac{7}{8}$   | $7 \frac{1}{2}$   | $4 \frac{1}{8}$   | 6                | $16 \frac{1}{4}$  | $\frac{5}{8}$ | 15.86          | 2400               |
| 14          | $\frac{1}{2}$ x 2.50  | $1 \frac{1}{8}$ | $8 \frac{3}{8}$   | $4 \frac{11}{16}$ | $6 \frac{1}{2}$  | 18                | $\frac{3}{4}$ | 21.58          | 3130               |
| 16          | $\frac{1}{2}$ x 3     | $1 \frac{1}{4}$ | $9 \frac{3}{8}$   | $5 \frac{3}{8}$   | $8 \frac{1}{4}$  | 21                | $\frac{3}{4}$ | 34.50          | 3970               |
| 18          | $\frac{1}{2}$ x 3     | $1 \frac{1}{4}$ | $10 \frac{7}{16}$ | 6                 | $9 \frac{1}{4}$  | $22 \frac{7}{8}$  | $\frac{3}{4}$ | 36.50          | 4200               |
| 20          | $\frac{1}{2}$ x 3     | $1 \frac{1}{4}$ | $11 \frac{5}{8}$  | $6 \frac{1}{2}$   | $10 \frac{1}{4}$ | $25 \frac{1}{4}$  | $\frac{3}{4}$ | 45.00          | 4550               |
| 24          | $\frac{5}{8}$ x 4     | $1 \frac{1}{2}$ | 14                | $7 \frac{7}{8}$   | $12 \frac{1}{4}$ | 30                | $\frac{7}{8}$ | 77.50          | 6160               |

| Project Information  |             | Approval Stamp |
|--|-------------|----------------|
| Project:   |             | Notes:         |
| Address:   | Contractor: |                |
| Date:  | Engineer:   |                |
| Approved <input type="checkbox"/> Approved as Noted <input type="checkbox"/> Not Approved <input type="checkbox"/> |             |                |