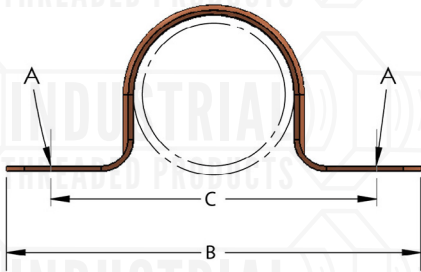

FIG. 231CT
COPPER TWO HOLE TUBING STRAP



Material: Carbon steel.
Finish: Copper plated.
Service: Designed as a light duty support for copper tubing. Attaches directly to horizontal or vertical structural member.
Ordering: Specify tube size and figure number.
Notes: Available domestic

PIPE SIZE	PIPE OD	MATERIAL SIZE	A HOLE SIZE	B	C	WGT EACH (lbs)
1/4	0.375	20ga x 1/2	3/16	1 3/4	1 1/8	0.01
3/8	0.500	20ga x 1/2		1 7/8	1 1/4	
1/2	0.625	20ga x 1/2		2 1/8	1 1/2	
3/4	0.875	20ga x 1/2		2 3/8	1 5/8	0.02
1	1.125	20ga x 1/2	7/32	2 7/8	2 1/4	
1 1/4	1.375	20ga x 1/2		3 1/8	2 1/2	
1 1/2	1.625	18ga x 3/4		3 5/8	2 3/4	0.05
2	2.125	18ga x 3/4		4 1/4	3 3/8	0.06

Project Information		Approval Stamp
Project:		Notes:
Address:	Contractor:	
Date:	Engineer:	
Approved <input type="checkbox"/> Approved as Noted <input type="checkbox"/> Not Approved <input type="checkbox"/>		