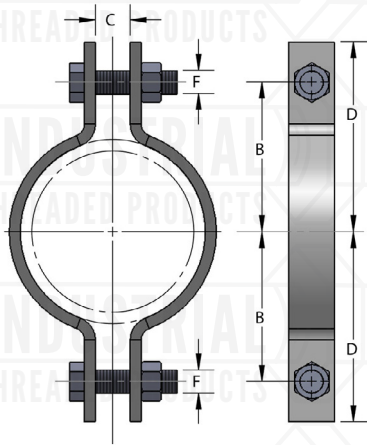



FIG. 212
STANDARD STEEL PIPE CLAMP



Manufactured in the USA



Material/Finish: Carbon steel 304 stainless steel 316 stainless steel
 Plain electro-galvanized

Service: Designed for the suspension of cold pipe lines or hot pipe lines where no insulation is required.

Approvals: Complies with Federal Specifications WW-H-171-E (Type# 4), A-A-1192 A (Type# 4), and MSS SP-58 and SP-69 (Type# 4).

Ordering: Specify pipe size, figure number and finish.

Notes: Available in 304 and 316 stainless steel and alloy steel.

PIPE SIZE	PIPE OD	MATERIAL SIZE S	BOLT F	B	C	D	WEIGHT EACH (lbs)	MAX REC LOAD (lbs)
1/2	0.840	11ga x 1	5/16	1 1/8	7/16	1 11/16	0.27	500
3/4	1.050	11ga x 1	5/16	1 1/4	7/16	1 13/16	0.30	500
1	1.315	11ga x 1	5/16	1 7/16	7/16	2	0.33	500
1 1/4	1.660	11ga x 1	5/16	1 9/16	7/16	2 1/8	0.36	500
1 1/2	1.900	11ga x 1	5/16	1 11/16	1/2	2 1/4	0.37	800
2	2.375	3ga x 1	1/2	2 5/16	1/2	3 3/16	1.04	1040
2 1/2	2.875	3ga x 1	1/2	2 5/8	3/4	3 1/2	1.19	1040
3	3.500	3ga x 1	1/2	2 7/8	3/4	3 3/4	1.27	1040
3 1/2	4.000	3ga x 1	1/2	3 1/8	3/4	4	1.43	1040
4	4.500	4ga x 1 1/4	5/8	3 5/8	3/4	4 1/2	1.94	1040
5	5.563	4ga x 1 1/4	5/8	4 1/8	7/8	5	2.20	1040
6	6.625	3/8 x 1 1/2	3/4	5	7/8	5 7/8	5.42	1615
8	8.625	3/8 x 1 1/2	3/4	6 1/8	1	7	6.51	1615
10	10.750	1/2 x 2	7/8	7 7/16	1	8 9/16	13.60	2490
12	12.750	1/2 x 2	7/8	8 7/16	1	9 9/16	16.05	2490
14	14.000	1/2 x 2 1/2	7/8	9 1/4	1 1/8	10 5/8	20.00	2490
16	16.000	1/2 x 2 1/2	7/8	10 1/4	1 1/8	11 5/8	22.00	2490
18	18.000	5/8 x 2 1/2	1	11 5/8	1 1/4	13	32.00	3060
20	20.000	5/8 x 2 1/2	1 1/8	12 3/4	1 3/8	14 1/8	36.00	3060

Project Information		Approval Stamp
Project:		Notes:
Address:	Contractor:	
Date:	Engineer:	
Approved <input type="checkbox"/>	Approved as Noted <input type="checkbox"/>	Not Approved <input type="checkbox"/>