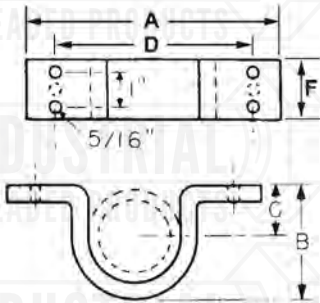



**FIG. 180
SHORT CLIP**



**Manufactured
in the USA**



Material: Carbon steel (304 and 316 stainless steel).
Finish: Plain or electro-galvanized.
Service: Designed to support pipe close to ceiling or wall.
Ordering: Specify size, figure number and finish.
Notes: Available in stainless steel and hot-dip galvanized. Sizes 1/2" to 2" are furnished with two screw holes. Sizes 2 1/2" to 4" are furnished with four screw holes.
 * Radius edge 1/2" to 2" with 2 holes.
 * Square edge 2 1/2" to 4" with four holes.

PIPE SIZE	PIPE OD	MATERIAL	A	B	C	D	F	WEIGHT EACH (lbs)	MAX REC LOAD (lbs)
1/2	0.840	11ga	3 3/16	1 1/8	9/16	2 1/16	1 1/4	0.165	300
3/4	1.050		3 1/2	1 3/8	5/8	2 3/8		0.190	
1	1.315		4	1 5/8	3/4	2 7/8		0.235	
1 1/4	1.660		4 7/8	1 7/8	15/16	3 5/16		0.260	
1 1/2	1.900	8ga	4 13/16	2 3/16	1 1/8	3 11/16	1 3/4	0.400	400
2	2.375		5 1/2	2 3/4	1 3/8	4 3/8		0.490	
2 1/2	2.875		6 3/8	3 1/8	1 5/8	5 3/8		0.910	
3	3.500		7 1/8	3 3/4	1 15/16	6 1/8		0.950	
3 1/2	4.000		7 3/8	4 5/16	2 3/16	6 3/8		1.050	
4	4.500		7 3/4	4 13/16	2 7/16	6 3/4		1.160	

Project Information		Approval Stamp
Project:		Notes:
Address:	Contractor:	
Date:	Engineer:	
Approved <input type="checkbox"/>	Approved as Noted <input type="checkbox"/>	Not Approved <input type="checkbox"/>