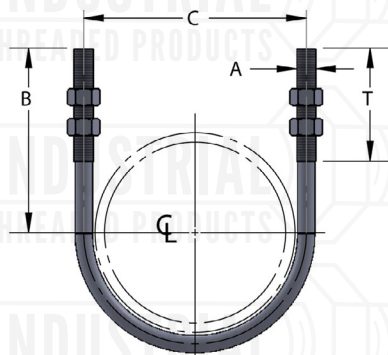

FIG. 137
STANDARD U-BOLT WITH 4 HEX NUTS

Material/Finish: Carbon steel ☐ 304 stainless steel ☐ 316 stainless steel ☐
 Plain ☐ electro-galvanized ☐

Service: Designed for support or guide of heavy loads.

Approvals: Complies with Federal Specifications WW-H-171-E (Type# 24), A-A-1192 A (Type# 24), and MSS SP-58 and SP-69 (Type# 24).

Ordering: Specify pipe size, figure number and finish. Sizes 1/2" to 1" can be furnished with 3/8" rod size.

Notes: U-bolts with longer tangents or longer threads are available. Also available with plastic coating.

Available domestic

| PIPE SIZE | PIPE OD | A | B | C | T | WEIGHT EACH (lbs) | MAX REC LOAD (lbs) |
|-----------|---------|--------|--------|---------|-------|-------------------|--------------------|
| 1/2 | 0.840 | 1/4-20 | 2 3/4 | 1 3/16 | 2 3/8 | 0.10 | 485 |
| 3/4 | 1.050 | 1/4-20 | 2 3/4 | 1 3/8 | 2 3/8 | 0.10 | 485 |
| 1 | 1.315 | 1/4-20 | 2 3/4 | 1 5/8 | 2 3/8 | 0.10 | 485 |
| 1 1/4 | 1.660 | 3/8-16 | 2 7/8 | 2 1/16 | 2 3/8 | 0.26 | 1220 |
| 1 1/2 | 1.900 | 3/8-16 | 3 | 2 3/8 | 2 1/2 | 0.28 | 1220 |
| 2 | 2.375 | 3/8-16 | 3 1/4 | 2 13/16 | 2 1/2 | 0.32 | 1220 |
| 2 1/2 | 2.875 | 1/2-13 | 3 3/4 | 3 7/16 | 3 | 0.70 | 2260 |
| 3 | 3.500 | 1/2-13 | 4 | 4 1/16 | 3 | 0.76 | 2260 |
| 3 1/2 | 4.000 | 1/2-13 | 4 1/4 | 4 9/16 | 3 | 0.80 | 2260 |
| 4 | 4.500 | 1/2-13 | 4 1/2 | 5 1/16 | 3 | 0.86 | 2260 |
| 5 | 5.563 | 1/2-13 | 5 | 6 1/8 | 3 | 1.00 | 2260 |
| 6 | 6.625 | 5/8-11 | 6 1/8 | 7 3/8 | 3 3/4 | 1.98 | 3620 |
| 8 | 8.625 | 5/8-11 | 7 1/8 | 9 3/8 | 3 3/4 | 2.26 | 3620 |
| 10 | 10.750 | 3/4-10 | 8 3/8 | 11 5/8 | 4 | 3.94 | 5420 |
| 12 | 12.750 | 7/8-9 | 9 5/8 | 13 3/4 | 4 1/4 | 6.40 | 7540 |
| 14 | 14.000 | 7/8-9 | 10 1/4 | 15 | 4 3/4 | 8.30 | 7540 |
| 16 | 16.000 | 7/8-9 | 11 1/4 | 17 | 4 3/4 | 9.20 | 7540 |
| 18 | 18.000 | 1-8 | 12 5/8 | 19 1/8 | 4 3/4 | 13.50 | 9920 |
| 20 | 20.000 | 1-8 | 13 5/8 | 21 1/8 | 4 3/4 | 14.60 | 9920 |
| 24 | 24.000 | 1-8 | 15 5/8 | 25 1/8 | 4 3/4 | 16.90 | 9920 |

| Project Information | | Approval Stamp |
|--|-------------|----------------|
| Project: | | Notes: |
| Address: | Contractor: | |
| Date: | Engineer: | |
| Approved <input type="checkbox"/> Approved as Noted <input type="checkbox"/> Not Approved <input type="checkbox"/> | | |