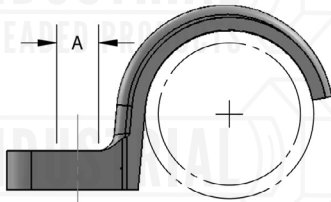



**FIG. 126  
ONE HOLE CLAMP**



**Material:** Malleable iron  
**Finish:** Electro-galvanized.  
**Service:** Designed for the support of conduit, cable or pipe on walls or sides of beams. Not recommended for horizontal use on ceilings or bottom of beams.  
**Ordering:** Specify pipe size and figure number.

PIPE SIZE	PIPE/CABLE/CONDUIT OD	HOLE DIAM A	BOLT/SCREW SIZE	WEIGHT EACH (lbs)
1/2	0.840	5/16	1/4	0.04
3/4	1.050	5/16	1/4	0.05
1	1.315	5/16	1/4	0.09
1 1/4	1.660	3/8	1/4	0.12
1 1/2	1.900	7/16	3/8	0.16
2	2.375	7/16	3/8	0.25
2 1/2	2.875	11/16	5/8	0.49
3	3.500	11/16	5/8	0.82
4	4.500	3/4	5/8	1.30

Project Information		Approval Stamp
Project:		Notes:
Address:	Contractor:	
Date:	Engineer:	
Approved <input type="checkbox"/>	Approved as Noted <input type="checkbox"/>	Not Approved <input type="checkbox"/>