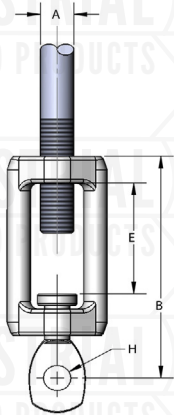

FIG. 114
TURNBUCKLE ADJUSTER



Material: Malleable iron.
Finish: Plain, copper plated.
Service: Designed to provide vertical rod adjustment with split ring hangers.
Approvals: Complies with Federal Specification WW-H-171-E (Type# 15), A-A-1192 A (Type# 15) and Manufacturers' Standardization Society MSS SP-58 and SP-69 (Type# 15).
Ordering: Specify rod size and figure number.
Notes: Available domestic

SIZE A	PIPE SIZE	B	E	H	WEIGHT EACH (lbs)	MAX REC LOAD (lbs)
3/8-16	1/2 to 2	4.300	2.000	0.410	0.30	610
1/2-13	2 1/2 to 3 1/2	4.300	2.000	0.410	0.28	610

Project Information		Approval Stamp
Project:		Notes:
Address:	Contractor:	
Date:	Engineer:	
Approved <input type="checkbox"/>	Approved as Noted <input type="checkbox"/>	Not Approved <input type="checkbox"/>